

# Crosby ELIMINATOR® Fittings

**Fatigue Rated**  
**Crosby 8/10™**

**"QT"**  
QUENCHED & TEMPERED

QUIC-CHECK®  
CE



**SEE APPLICATION AND WARNING INFORMATION**

Para Español: [www.thecrosbygroup.com](http://www.thecrosbygroup.com)

On Pages 262-263

**A-1361**



The Crosby ELIMINATOR® combines selected features and functionality of a master link, connecting link, grab hook and adjuster legs to provide you with one fitting that is suitable for applications that require an adjustable length chain sling.

- Forged Alloy Steel - Quenched and Tempered.
- Innovative two piece design allows for maximum flexibility.
- Individually Proof Tested with certification.
- The Crosby ELIMINATOR®, if properly installed and locked, can be used for personnel lifting applications and meets the intent of OSHA Rule 1926.1431(g).
- Suitable for use with Grade 100 and Grade 80 chain.
- Engineered to accommodate optional locking pins that can be inserted to "lock" the shortened chain legs into place.
- Fatigue rated at 1-1/2 times the Working Load Limit at 20,000 cycles.
- Use the A-1361 and A-1362 in combination to make 3 leg chain slings.
- Load pin assembly instructions on page 269.
- "Look for the Platinum Color - Crosby Grade 100 Alloy Products."
- All sizes are **RFID EQUIPPED**.

**A-1362**

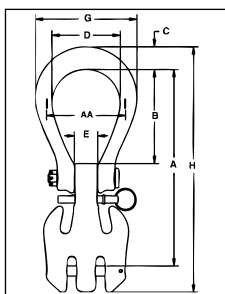
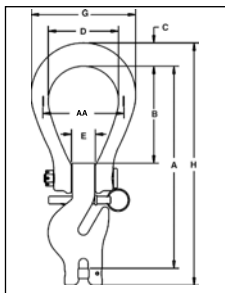

## A-1361 Crosby ELIMINATOR® Single Hook

Chain Size		Frame Size	Working Load Limit (t)*	A-1361 Stock No.	L-1361 Stock No.	Weight Each (kg)	Dimensions (mm)							
(in.)	(mm)						A	B	C	D	E	AA	G	H
1/4	7	2	2.0	1049797	1049802	1.76	208	99.0	22.9	76.2	23.9	89.0	112	248
5/16	8	2	2.6	1049804	1049809	1.76	208	99.0	22.9	76.2	23.9	89.0	112	248
3/8	10	3	4.0	1049813	1049818	2.94	255	122	29.5	88.9	28.7	102	132	306
1/2	13	4	6.8	1049822	1049827	6.12	327	152	41.4	105	33.3	127	162	395
5/8	16	5	10.3	1049831	1049836	10.9	388	175	49.8	121	41.4	152	188	472

\* Proof tested at 2.5 times the Working Load Limit. Minimum Ultimate Load is 4 times the Working Load Limit.

## A-1362 Crosby ELIMINATOR® Double Hook

Chain Size		Frame Size	Working Load Limit (t)*	A-1362 Stock No.	L-1362 Stock No.	Weight Each (kg)	Dimensions (mm)							
(in.)	(mm)						A	B	C	D	E	AA	G	H
1/4	7	2	3.9	1049859	1049913	2.13	208	99.0	22.9	76.2	23.9	89.0	112	257
5/16	8	2	5.0	1049868	1049922	2.13	208	99.0	22.9	76.2	23.9	89.0	112	257
3/8	10	3	8.0	1049877	1049931	3.67	255	122	29.5	88.9	28.7	102	132	319
1/2	13	4	13.6	1049886	1049940	7.84	327	152	41.4	105	33.3	127	162	413
5/8	16	5	20.5	1049895	1049949	14.3	388	175	49.8	121	41.4	152	188	491

\* Proof tested at 2 times the Working Load Limit. Minimum Ultimate Load is 4 times the Working Load Limit.

## Using Crosby ELIMINATOR® in 3 and 4 Leg Slings

See page 216-217 for basic chain sling components.

Spectrum 10® Chain Size		Master Link A-342 Stock No.	Master Link A-1342 Stock No.	Crosby ELIMINATOR® Single A-1361 Stock No.	Crosby ELIMINATOR® Double A-1362 Stock No.
(in.)	(mm)				
1/4 (9/32)	7	1014285	1011412	1049797	1049859
5/16	8	1014319	1011421	1049804	1049868
3/8	10	1014331	1011430	1049813	1049877
1/2	13	1014348	1011449	1049822	1049886
5/8	16	1014365	1011458	1049831	1049895

Use one of either A-342 or A-1342 master link.  
Use one of each when making three leg sling.

Spectrum 10® Chain Size		Master Link A-342 Stock No.	Master Link A-1342 Stock No.	Crosby ELIMINATOR® Single A-1361 Stock No.	Crosby ELIMINATOR® Double A-1362 Stock No.
(in.)	(mm)				
1/4 (9/32)	7	1014285	1011412	–	1049859
5/16	8	1014319	1011421	–	1049868
3/8	10	1014331	1011430	–	1049877
1/2	13	1014348	1011449	–	1049886
5/8	16	1014365	1011458	–	1049895

Use one of either A-342 or A-1342 master link.  
Use two A-1362 fittings when making Quad leg sling.