

# Mooring Spelter Sockets

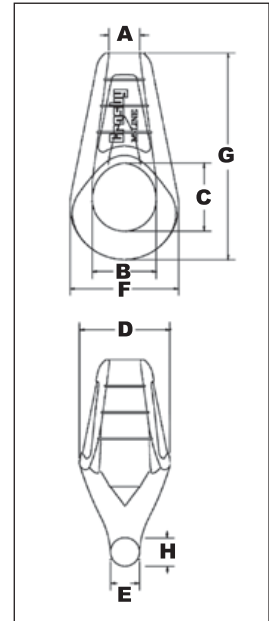

**G-517  
Mooring  
Spelter Socket**

- Wide range of sizes available:
  - 32mm through 102mm Wireline
- “M-Line” socket terminations have a 100% efficiency rating, based on the catalog strength of the wire rope. Ratings are based on recommended use with 6 x 7, 6 x 19, or 6 x 37, IPS or XIP (EIP), XXIP (EEIP), RRL, FC, or IWRC wire rope. Strand constructed with minimal number of wires (e.g. 1 x 7) requires special consideration that socket basket length be five (5) times the strand diameter or fifty (50) times the wire diameter, whichever is the greater.
- Galvanized finish
- Designed for today’s higher strength classes of wire rope.
- Design of bail allows for easy connection to shackles and other connecting links.
- Socket design utilizes features to keep cone from rotating.



All Cast Mooring Sockets are Individually Magnetic Particle Inspected and Ultrasonic Inspected.

## G-517 “M-Line” Mooring Sockets

Wire Rope Size		Ultimate Load (t)	G-517 Stock No.	Weight Each (kg)	Dimensions (mm)							
(mm)	(in)				A	B	C	D	E	F	G	H
32-35	1-1/4 - 1-3/8	113	1004943	7.7	41.4	78.5	92.2	113	36.6	130	277	38.9
38-41	1-1/2 - 1-5/8	136	1004961	13.6	49.5	93.7	110	138	40.6	160	330	46.0
44-48	1-3/4 - 1-7/8	181	1004989	19.5	56.6	106	115	160	46.7	183	358	53.1
50-54	2 - 2-1/8	227	1005002	25.9	63.5	121	134	178	53.1	210	407	56.9
57-60	2-1/4 - 2-3/8	277	1005020	34.5	70.6	133	146	196	58.7	233	455	66.6
64-67	2-1/2 - 2-5/8	363	1005048	48.1	77.5	149	170	217	68.3	257	505	67.6
70-73	2-3/4 - 2-7/8	454	1005066	62.6	84.6	165	181	237	76.2	282	549	63.0
76-79	3 - 3-1/8	544	1005084	87.5	89.9	184	197	262	82.6	313	597	82.3
82-86	3-1/4 - 3-3/8	635	1005105	104	96.8	194	224	278	88.9	334	654	87.1
88-92	3-1/2 - 3-5/8	735	1005123	127	105	203	230	298	93.7	355	703	105
95-102	3-3/4 - 4	907	1005141	174	112	222	267	328	93.7	403	765	113