

## DC500 DRUM CLAMP

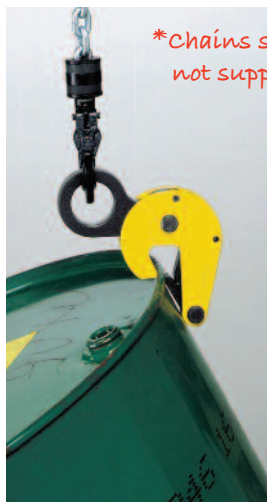

The **DC500 drum clamp** has been designed to lift and transport steel drums. If moving empty or sealed drums then one clamp is sufficient on its own. Should you be lifting an open full drum, then two clamps should be used with a two leg chain sling.

This clamp is extremely light weight and very quick and easy to use.

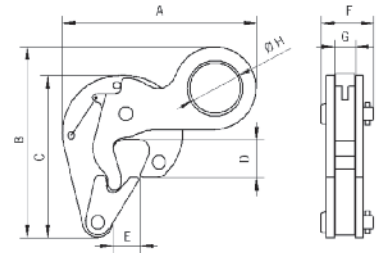

Model	WLL kg*	A mm	B mm	C mm	D mm	E mm	F mm	G mm	H mm	Weight kg*	Price £*
DC500	500	152	150	127	30	21	41	17	40	1.2	<b>£132</b>

\*Per clamp. **NB: For use with STEEL DRUMS only.**

## DCV500 'VERTICAL LIFT' DRUM CLAMP



The **DCV500 drum clamp** has been designed to lift and transport steel drums in the vertical position. One clamp can be used to lift drums with or without their lids by gripping the rim of the drum.

Its light weight and small overall design makes it ideal for picking up drums that sit tightly on pallets.

The centre of gravity of the drum is below the lifting point during transportation.

The DCV500 is also available with a 'lock on / open latch'. Please contact the Camlok sales team for further details.

**NB: For use with STEEL DRUMS only.**

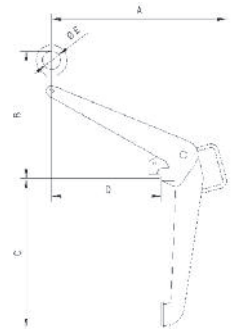

Model	WLL kg	A mm	B mm	C mm	D mm	E mm	Weight kg*	Price £*
DCV500	500	479	350	410	300	50	7	<b>£153</b>

\*Per clamp.

## DA/DAF 'LOW HEADROOM' DRUM GRABS



The **DA drum grab** is designed for the vertical transportation of steel drums. The jaws grab under the lip of the drum with its form-fitting connection.

The **DAF drum grab** works on the same principle as the DA grab, but has the added benefit of adjustable arms that can be used with an overhead crane or forklift.

**NB: For use with STEEL DRUMS only.**

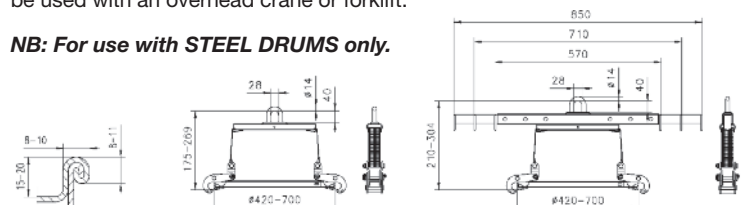

Model	WLL kg	Jaw Capacity mm	Weight kg*	Price £*
DA	350	420 - 700	3.5	<b>£362</b>
DAF	350	420 - 700	6.0	<b>£405</b>

\*Per clamp.