

Wireless Low Headroom Link



Features and benefits:

- Low headroom
- Range from 1t to 30t
- Lightweight and portable
- Accepts standard shackles
- Constructed from high strength alloy steel
- Proprietary 2.4 GHz wireless
- Industry leading wireless range of 700m or 2300ft
- Error free data transmission
- Environmentally sealed to IP67 or NEMA 6
- 90db Audible overload alarm
- Unmatched battery life of 1200 hours
- Internal antennae
- Remote on-off

The versatile WDB is supplied with an update rate of 3 Hz and can be easily configured to run at industry leading speeds of up to 200 Hz.

Data is transmitted wirelessly utilising the latest in IEEE 802.15.4 (2.4 GHz) technology providing safe, high integrity, error free transmission of both static weight and dynamic loads to Straightpoint's SW-HHP wireless handheld display or up to 100 WDB load cells may be connected to our SW-MWLC multi load cell data logging software.

Environmentally sealed in an aerospace aluminium enclosure and sealed to IP67 or NEMA 6 the WDB utilises easily sourced AA alkaline batteries and features advanced circuitry designed to protect the unit from damage associated with incorrectly installed batteries.

This advanced circuitry extends battery life and the use of easily sourced alkaline batteries eliminates issues associated with rechargeable battery pack charging, failure and replacement.

Now available as a wireless product the Straightpoint range of Low Headroom Links are designed to provide accurate measurement of loads in the most challenging applications where headroom restrictions are a major factor.

Constructed from high strength alloy steel and exposed to an array of testing during development, this impressive range of load cells is designed to work with industry standard shackles from manufacturers such as Crosby and Van Beest. Applications include weighing, lifting, force measurement and load monitoring of structures such as lighting trusses, hoist mountings and fly line tensioning.

The unique low headroom design combines the ability to lift loads with capacities up to 30t and features industry leading wireless technology and range of 700m or 2300ft.



making the lifting industry a safer place

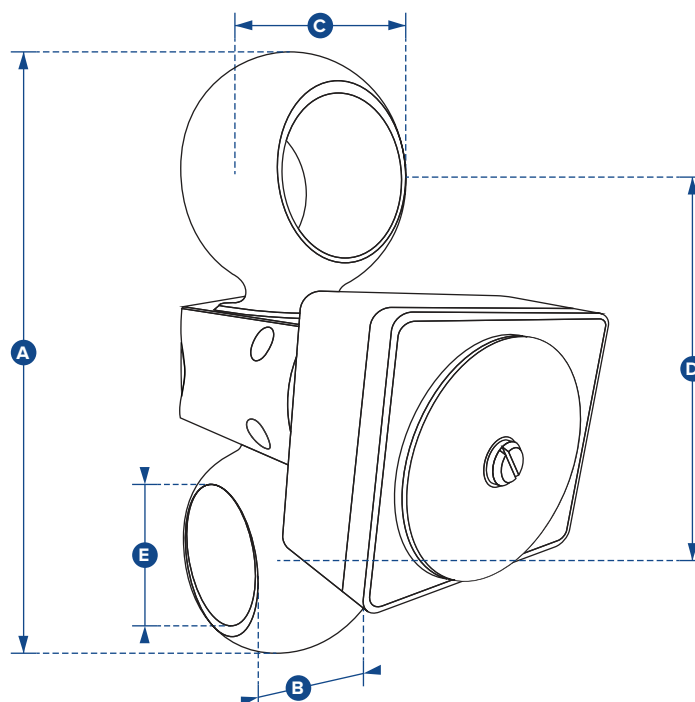

| Part Number | WDB1T | WDB3T | WDB5T | WDB10T | WDB20T | WDB30T |
|----------------|----------------------------------|----------------|----------------|-----------------|-----------------|-----------------|
| Capacity | 1000kg 2200lb | 3te 6600lb | 5te 11000lb | 10te 22000lb | 20te 44000lb | 30te 66000lb |
| Resolution | 0.5kg 1lb | 0.001te 2lb | 0.001te 2lb | 0.002te 4lb | 0.005te 10lb | 0.005te 10lb |
| Units | tonne lb | | | | | |
| Weight | 1kg 2.2lb | 1.2kg 2.6lb | 2kg 4.4lb | 2.5kg 5.5lb | 4kg 8.8lb | 6.2kg 13.7lb |
| Safety Factor | 5:1 | | | | | |
| Battery Type | Load cell 4 x AA Alkaline | | | | | |
| Battery Life | Load cell 1,200 hours continuous | | | | | |
| Operating Temp | -10°C to +50°C / 14°F to 122°F | | | | | |
| Accuracy | ± 0.3% of applied load | | | | | |
| Frequency | 2.4 GHz | | | | | |
| Range | 700 metres / 2300 feet | | | | | |
| Data Rate | 3Hz up to 200Hz | | | | | |
| Protection | IP65 / NEMA 4X | | | | | |
| Dimension A | 110 4.33" | 129 5.08" | 165 6.50" | 205 8.07" | 249 9.80" | 248 9.76" |
| Dimension B | 18 0.71" | 25 0.98" | 33 1.30" | 41 1.61" | 66 2.60" | 58 2.28" |
| Dimension C | 33 1.30" | 35 1.38" | 50 1.97" | 63 2.48" | 90 3.54" | 87 3.43" |
| Dimension D | 74 2.91" | 88 3.46" | 111 4.37" | 135 5.31" | 153 6.02" | 150 5.91" |
| Dimension ØE | 18 0.71" | 21 0.83" | 27 1.06" | 37 1.46" | 53 2.09" | 44 1.73" |
| Crosby Shackle | G2130-2T | G2130-3.25T | G2130-6.5T | G2130-12T | G2130-25T | G2140-30T |