

End Links and Weldless Rings



G-340 / S-340
Weldless End Link

- Forged carbon steel - Quenched and Tempered
- Self Colored or Hot Dip galvanized.

G-340 from 16 mm thru 22mm meet the performance requirements of Federal Specification RR-C-271 , Type XV, except for those provisions required of the contractor. For additional information, see page 450.

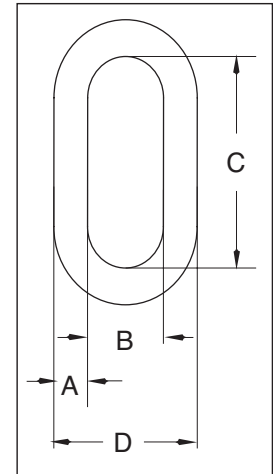

G-340/S-340 Weldless End Links

Stock No.		Working Load Limit (t)*	Weight Each (kg)	Dimensions (mm)			
G-340 Galv.	S-340 S.C.			A	B	C	D
1014057	1014066	1.13	.07	8	12.7	44.5	30.0
1014075	1014084	1.72	.10	10	14.2	47.8	35.1
1014093	1014100	2.95	.22	13	19.1	60.5	46.0
1014119	1014128	4.22	.44	16	25.4	82.5	59.0
1014137	1014146	6.35	.68	19	28.7	89.0	68.0
1014155	1014164	5.44	1.17	22	51.0	130	95.5
1014173	1014182	6.89	1.79	25	57.0	146	108
1014191	1014208	11.97	3.31	32	63.5	178	127
1014217	1014226	13.61	4.71	35	70.0	197	140

*Ultimate Load is 5 times the Working Load Limit. Based on single leg sling (in-line load), or resultant load on multiple legs with an included angle less than or equal to 120°.



S-643
Weldless Rings

- Forged carbon steel - Quenched and Tempered.
- Self Colored

Weldless Rings meet the performance requirements of Federal Specification RR-C-271F Type VI, except for those provisions required of the contractor. For additional information, see page 450.

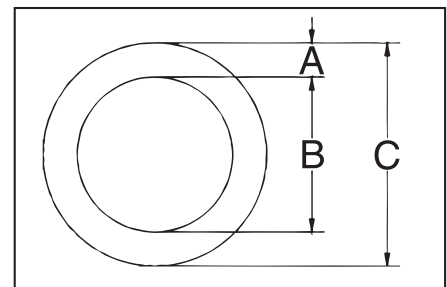

S-643 Weldless Rings

Size (mm)	S-643 Stock No	Working Load Limit Single Pull (t)*	WeightEach (kg)	Dimensions (mm)		
				A	B	C
22.2 x 102	1013780	3.27	1.23	22.2 x 102	102	146
22.2 x 140	1013806	2.54	1.57	22.2 x 140	140	184
25.4 x 102	1013824	4.90	1.67	25.4 x 102	102	152
28.6 x 152	1013842	4.72	2.99	28.6 x 152	152	210
31.8 x 127	1013860	7.71	3.09	31.8 x 127	127	191
34.9 x 152	1013888	8.62	4.59	34.9 x 152	152	222

*Ultimate Load is 6 times the Working Load Limit.