

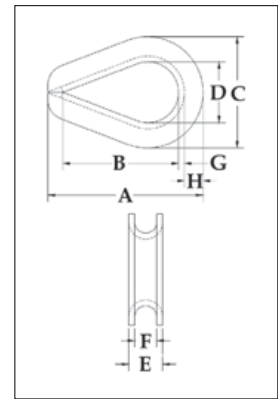

**G-414**

G-414 meets the performance requirements of Federal Specification FF-T-276b Type III, except for those provisions required of the contractor. For additional information, see page 444.

- Available in Hot Dip galvanized or Stainless Steel (Type 304).
- Stainless steel recommended for more corrosive environments where greater protection is required.
- Greater protection against wear and deformation of the wire rope eye.
- Longer service life.
- Meets the performance requirements of EN13411-1:2002.



## Extra heavy Wire Rope Thimbles

Rope Dia.		Stock No.		Weight Per 100 (kg)	Dimensions (mm)							
(mm)	(in)	G-414 Galv.	SS-414 Stainless		A	B	C	D	E	F	G	H
6-7	1/4	1037639	1037960	2.95	55.5	41.4	38.1	22.4	11.2	7.10	1.50	5.85
* 8	5/16	1037657	1037988	5.35	63.5	47.8	46.0	26.9	14.0	8.65	2.05	7.10
* 9-10	3/8	1037675	1038004	9.80	73.0	54.0	54.0	28.7	16.8	10.4	2.80	8.65
11-12	7/16	1037693	-	15.7	82.5	60.5	60.5	31.8	18.8	11.9	3.30	9.65
* 13-15	1/2 - 9/16	1037719	1038022	23.1	92.0	70.0	70.0	38.1	23.4	13.5	3.55	10.4
* 16	5/8	1037755	1038040	34.3	108	82.5	79.5	44.5	26.2	16.8	4.05	12.7
* 18-20	3/4	1037773	1038068	72	127	95.5	96.5	51.0	33.0	19.8	5.60	16.8
22	7/8	1037791	-	81	140	108	108	57.0	37.3	23.9	5.60	19.1
24-26	1	1037817	-	142	156	114	125	63.5	44.5	26.9	6.35	22.4
28-32	1-1/8 - 1-1/4	1037835	-	181	178	130	149	73.0	47.8	33.3	6.35	28.7
32-35	1-1/4 - 1-3/8	1037853	-	402	230	165	173	89.0	57.2	36.6	9.65	28.7
35-38	1-3/8 - 1-1/2	1037871	-	587	229	159	181	89.0	66.5	39.6	12.7	28.7
40	1-5/8	1037899	-	771	286	203	207	102	76.2	43.7	12.7	35.1
44	1-3/4	1037915	-	805	310	229	216	114	77.7	46.7	12.7	33.3
48-52	1-7/8 - 2	1037933	-	1259	384	305	264	152	85.9	53.0	12.7	38.1
56	2-1/4	1037951	-	1792	435	356	302	178	98.6	60.5	16.0	41.4

\*SS-414 sizes available in stainless steel type 304



**G-414 SL**

G-414 SL meets the performance requirements of Federal Specification FF-T-276b Type III, except for those provisions required of the contractor. For additional information, see page 452.

- Prevents the shackle from being removed and replaced in the field, which could compromise the certified integrity of the sling assembly.
- Available in Hot Dip galvanized. Crosby's shackle locking thimbles are galvanized after the welding of the wedge has been completed.
- Greater protection against wear and deformation of the wire rope eye.
- Longer service life.
- Meets the performance requirements of EN13411-1:2002

Scan our QR code with your smart device to visit the online flyer.

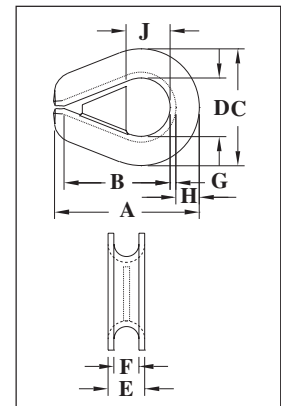

## Extra Heavy Wire Rope Thimbles (Shackle-Loc)

Rope Dia.		Stock No.		Weight Per 100 (kg)	Dimensions (mm)								
(mm)	(in)	G-414 Galv.			A	B	C	D	E	F	G	H	J
* 9-10	3/8	1036800		9.80	73.0	54.0	54.0	28.7	16.8	10.4	2.80	8.65	20.5
* 13-15	1/2 - 9/16	1036808		23.1	92.0	70.0	70.0	38.1	23.4	13.5	3.55	10.4	28.4
* 16	5/8	1036817		34.3	108	82.5	79.5	44.5	26.2	16.8	4.05	12.7	31.7
* 18-20	3/4	1036826		72	127	95.5	96.5	51.0	33.0	19.8	5.60	16.8	38.1
22	7/8	1036835		81	140	108	108	57.0	37.3	23.9	5.60	19.1	41.4
24-26	1	1036844		142	156	114	125	63.5	44.5	26.9	6.35	22.4	47.7
28-32	1-1/8 - 1-1/4	1036853		181	178	130	149	73.0	47.8	33.3	6.35	28.7	54.1
35-38	1-3/8 - 1-1/2	1036862		587	229	159	181	89.0	66.5	39.6	12.7	28.7	63.5